

# TR-WE45-B-IN PTZ Dome Gooseneck Bracket Mount



## Specifications

Bracket	TR-WE45-B-IN
Application	outdoor, for PTZ dome camera
Dimensions(L x H)	879mmx831mm (34.6" x32.7")
Weight	4.3kg(9.47lb)
Material	Aluminum alloy,

## Dimensions

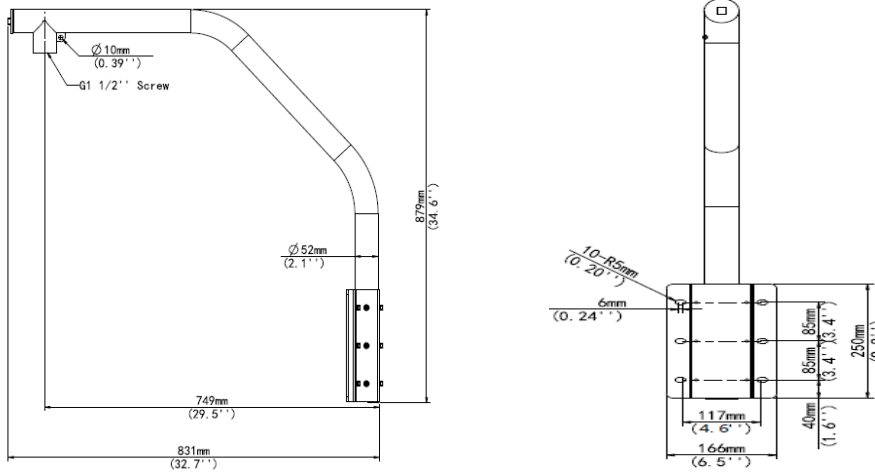

**Zhejiang Uniview Technologies Co.,Ltd.**

©2015 Zhejiang Uniview Technologies Co.,Ltd. All rights reserved.

\*Product specifications and availability are subject to change without notice.