

BT8312

SLIMLINE SOFT-OPEN FULL-SERVICE VIDEOWALL MOUNT

Designed to make video wall installations as quick and simple as possible, this modular video wall mount can be used to create unlimited video wall configurations in both landscape and portrait format. The BT8312 low profile design is ideal for mounting into walls with a shallow recess or when space in front of the wall is minimal. 8 points of micro-adjustment makes accurate screen alignment quick and easy and the soft opening features a controlled release enabling access to the rear of the mounted screen for servicing and maintenance.



SPECIFICATIONS

Recommended screen size	42" - 75" (46" - 75" in portrait)
Max load	50kg
VESA® compatibility as standard	200 x 100 up to 400 x 400
VESA® compatibility with adaptors	up to 600 x 400*
Flat to wall depth	69.5mm* (+/-7.5mm with micro-adjustment)
Popped out depth	222.5mm* (+/-7.5mm with micro-adjustment)
Tool-less micro-adjustment	+/-7.5mm per corner
Screen height adjustment	+15mm

FEATURES

- Slim design ideal for low profile installs on walls & recesses
- 1 Modular mount for an unlimited number of videowall configurations
- 2 Pop-out system with soft opening provides safe and easy service access
- 3 8 points of micro-adjustment for depth, height & lateral screen adjustment
- 4 Tool-less micro-adjustment at each corner for seamless display alignment
- Suitable for landscape or portrait screen mounting
- Keyhole mounting for quick and easy installation
- Integrated locking mechanism prevents accidental pop-out of mount
- Safety screws help prevent unauthorised removal of screens
- Suitable for both wall or pole mounting
- Spacers kits are available separately to speed up installation times
- Adaptor arms for VESA 800 x 400 fixings (BT7565) available separately



RECOMMENDED MAX SCREEN	MAX LOAD	MAX VESA	MICRO ADJUSTMENT	POST INSTALL ALIGNMENT	COLLAR COMPATIBLE	QR CODE
75" / 190cm	50kg	600 x 400				

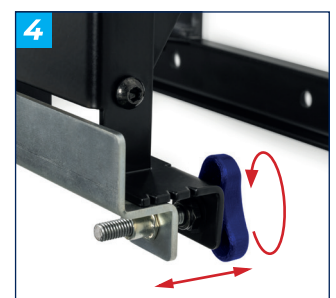
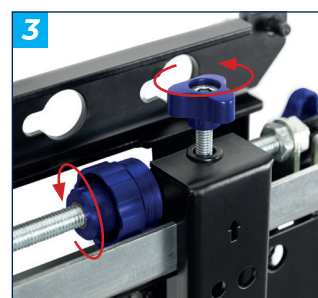
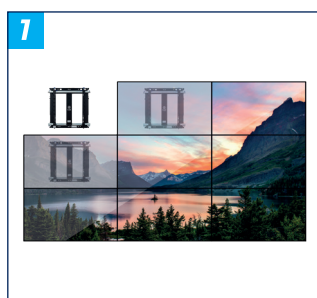

*Please note using the included Interface Adaptor Arms to mount VESA 600 x 400 screens will increase the total depth of the product by 6mm for a total depth of: 75.5mm or 228.5mm whilst popped out.

BT8312

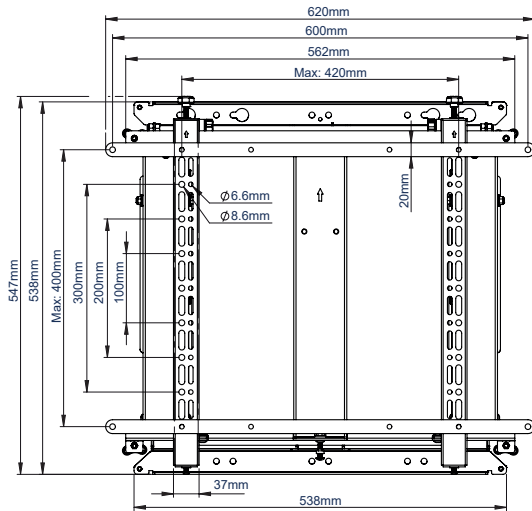

FRONT VIEW
WITH ADAPTOR ARMS

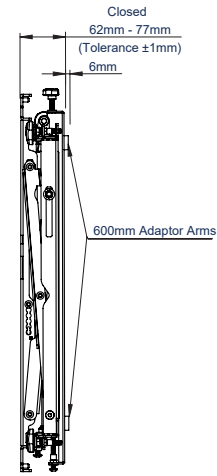

SIDE VIEW
CLOSED

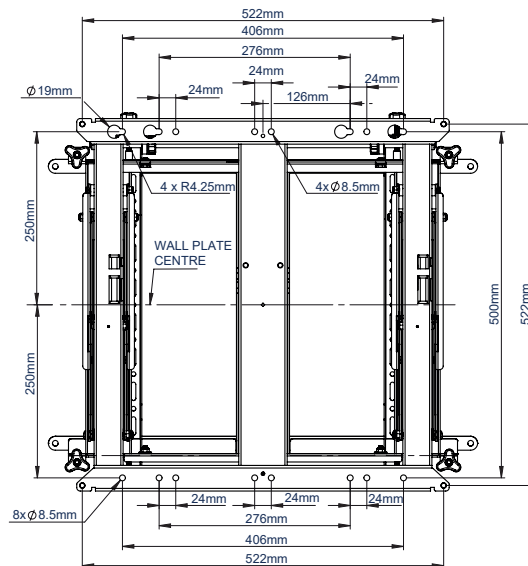

REAR VIEW
WITH ADAPTOR ARMS

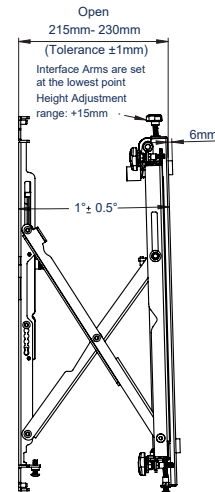

SIDE VIEW
OPEN

ORDERING INFORMATION

COLOUR	ORDER REF	EAN
Black	BT8312/B V2	5019318081231

RELATED PRODUCTS

PRODUCT CODE	NAME	DESCRIPTION
BT8312-SP	Mounting Template Spacers	Speed up BT8312 installation with quick positioning and calculation
BT7565	Interface Adaptor Arms	Designed to increase the VESA mounting pattern of smaller mounts
BT7822	Heavy Duty Floor / Ceiling Mount	Use in conjunction with B-Tech poles & collars to create pole mounted solutions
BT7850	Ø50mm Poles	Available in 5 lengths and can be used to create multiple pole mounted solutions

© 2018 B-Tech AV Mounts Co., Ltd. All rights reserved.
The information in this specification sheet reflects the current technical specifications at the time of printing.
We reserve the right to change the technical or physical specifications without prior notice. The B-Tech name and the B-Tech logo are registered trademarks of B-Tech AV Mounts Co., Ltd.
B-Tech is not responsible for loss or damage caused by improper installation or mounting on unstable structures. Any reproduction or reuse of information or specification of any part of this specification sheet is strictly prohibited unless prior written permission is granted by B-Tech AV Mounts Co., Ltd. 120618

SS-V4-BT8312-V2-040124