

FLAT SCREEN WALL MOUNT FOR SCREENS UP TO 80"

B-Tech Elements products offer the core traits that B-Tech is known for, exceptional build quality, strength, and reliability, without some of the premium features typically reserved for our flagship mounts. Designed for large-sized screens, the **BT5442** is a slim profile flat screen wall mount capable of mounting displays of up to 70kg at a depth of just 27mm from the wall. Perfect for hospitality and similar applications, the mount includes a universal interface compatible with VESA patterns up to 650 x 400mm. For added convenience, built-in lateral adjustment and a quick-release locking mechanism are featured, ensuring a flexible, hassle-free installation.

SPECIFICATIONS

Recommended screen size	up to 80"
Max load	70kg
VESA® & non-VESA fixings	up to 650 x 400mm
Distance from wall	27mm

FEATURES

- 1 Low profile design mounts screen only 27mm from the wall
 - 2 Lateral adjustment of the screen once mounted
 - 3 Easy to use locking mechanism with pull-to-release cord
 - 4 Simple 'hook-on' installation with all mounting hardware included
- Contemporary design featuring aesthetic end caps

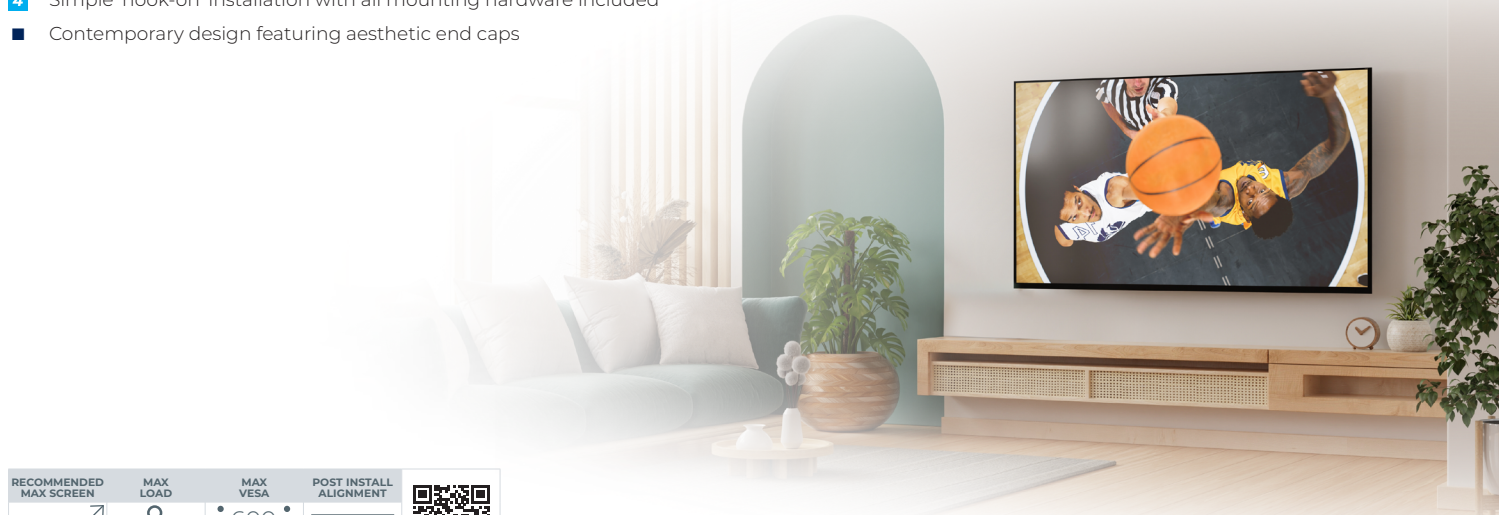

RECOMMENDED MAX SCREEN	MAX LOAD	MAX VESA	POST INSTALL ALIGNMENT	QR CODE
80" 203cm	70kg	600 x 400	← →	

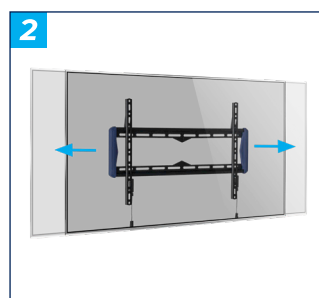
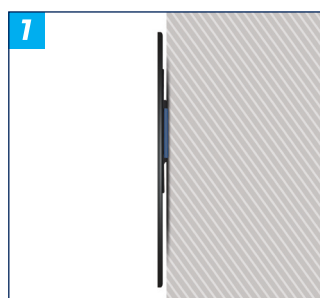

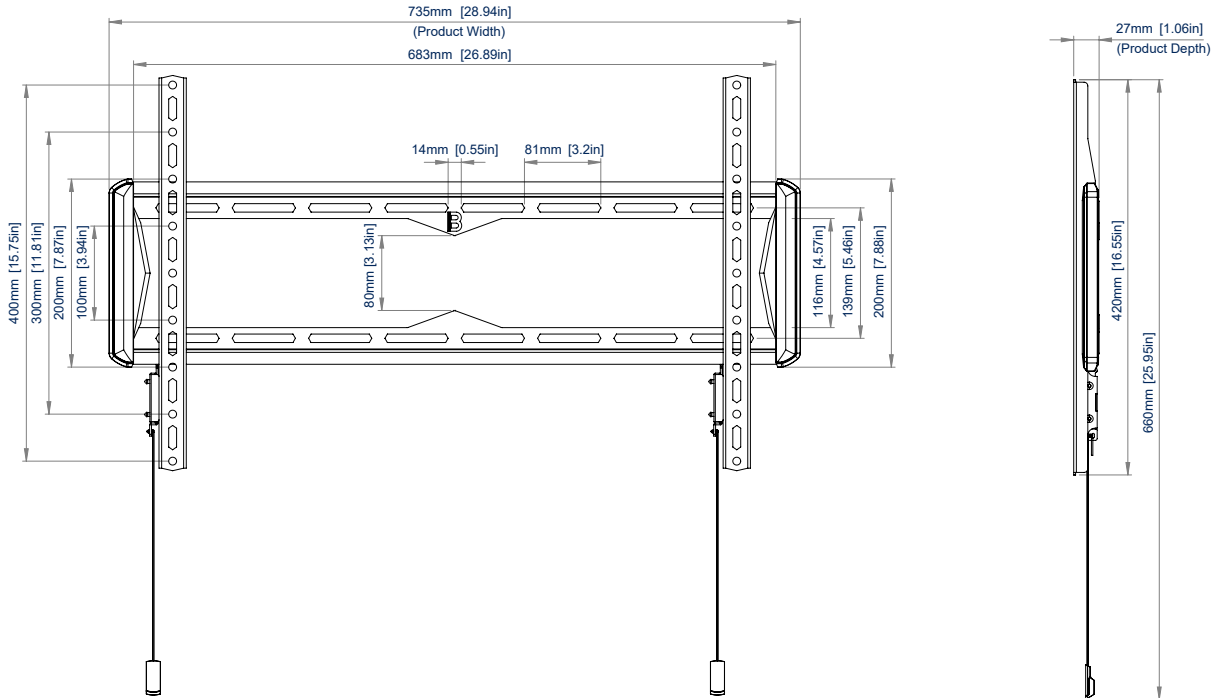

FRONT VIEW

SIDE VIEW



BOTTOM VIEW

ORDERING INFORMATION

COLOUR	ORDER REF	EAN
Black	BT5442/B	5019318308772

RELATED PRODUCTS

PRODUCT CODE	NAME	DESCRIPTION
BT5441	Fixed Flat Screen Wall Mount	Designed to mount screens up to 65"
BT8432	Flat Screen Wall Mount with Tilt	Designed to mount screens up to 80"
BT8228	Flat Screen Wall Mount with Tilt & Swivel	Double Arm solution designed to mount screens up to 120"
BT9903	XL Fixed Flat Screen Wall Mount	Designed to mount screens up to 120"

© 2016 B-Tech, All Rights Reserved. The information this specification sheet reflects the current technical specifications at the time of printing. We reserve the right to change the technical or physical specifications without prior notice. The B-Tech name and the B-Tech logo are registered trademarks of B-Tech, All Mounts Corporation Ltd. B-Tech is not responsible for any damage or loss caused by improper installation or mounting on unstable structures. Any reproduction or use without our express permission is prohibited. All rights reserved. Identification sheet is strictly confidential unless prior written permission is granted by B-Tech, All Mounts Corporation Ltd. 0421.

SS-V1-BT5442-11.0924